



Celtic Fields

The Exe



3 bedroom home with a **strong ecological focus**

SC+H
Building a sustainable future



award winning design with a real purpose

Ground Floor

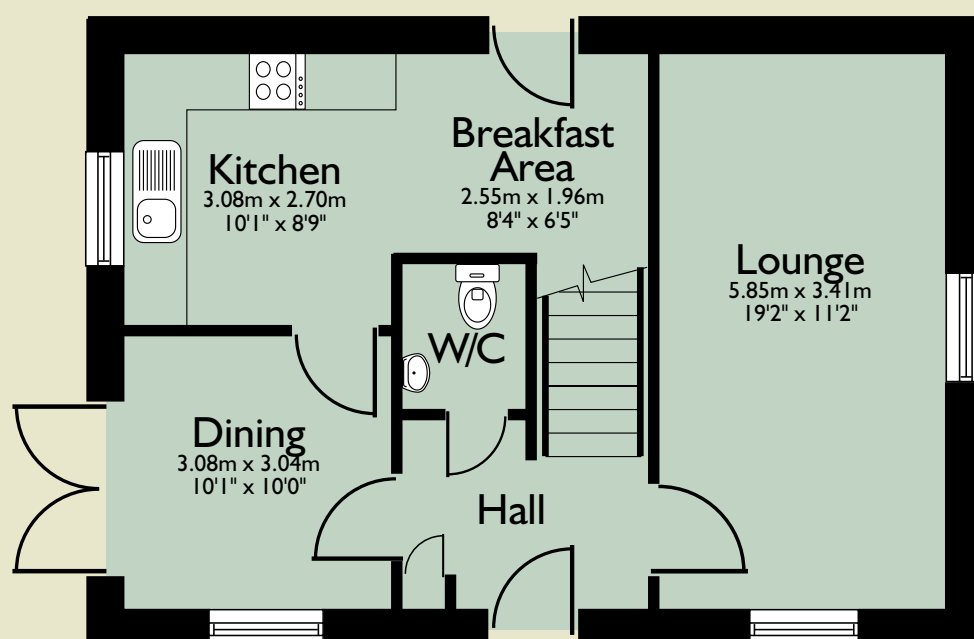

The Exe
3 bedroom
detached house
 Plot 11

External

- Front and rear gardens, turfed or seeded depending on season.
- Flagstone/decked area.
- Light.

Internal

- Satellite preparation, TV and telephone sockets to living room and master bedroom.
- Centre pendants to all living rooms. Down lights to bathrooms and kitchens.
- Choice of carpet and laminate finish to floors from selected range*.
- Clear Pine or Oak finish internal doors with stainless steel handles.
- Hard wood front door with smooth finish.
- Timber frame double glazed windows.



homes with a strong ecological focus

First Floor

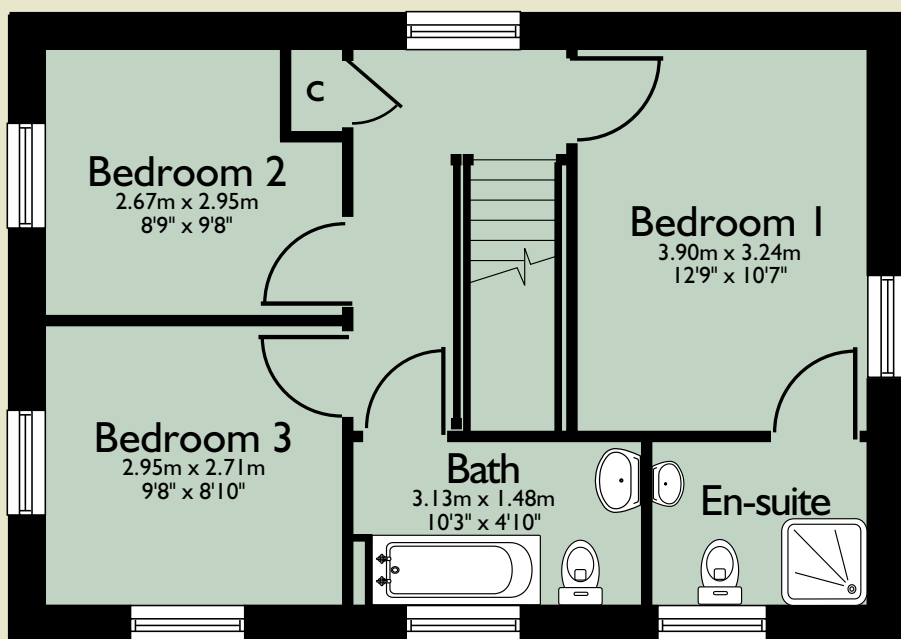

Kitchens

- Choice of kitchens*.
- Integrated hob, oven and extractor, fridge /freezer, dishwasher.
- Up-stands to work surfaces with splash back behind hob.
- White rimmed recessed down lights.

*dependent upon stage of construction

Bathrooms

- Choice of ceramic tiles*.
- Contemporary white suite with chrome fittings.
- Wall mounted over-bath shower with full height ceramic wall tiling in shower.
- Shaver point.
- White recessed down lights.
- Enclosed shower to en-suite with stainless steel handles (*where applicable*), floor to ceiling tiling in shower.
- Towel rail.
- Toilet roll holder, mirror above sink.

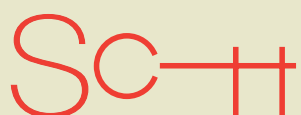

Building a sustainable future
www.swancountryhomes.co.uk

The Selling Agents and the Developer reserve the right to alter and amend the information given in this brochure if necessary. Nothing contained herein shall be, or shall be deemed to be part of any contract. The approximate dimensions quoted indicate maximum room sizes and are scaled from plans before construction has commenced. Potential buyers should note that no allowance has been made for the thickness of plaster or skirting boards, and all dimensions may vary during construction. They are not intended to be used for carpet sizes, appliance spaces or items of furniture. Purchasers are strongly advised to confirm all measurements of their chosen property on site. Variation in the construction and landscaping should be expected. Illustrations are computer generated impressions and should be used for guidance only.

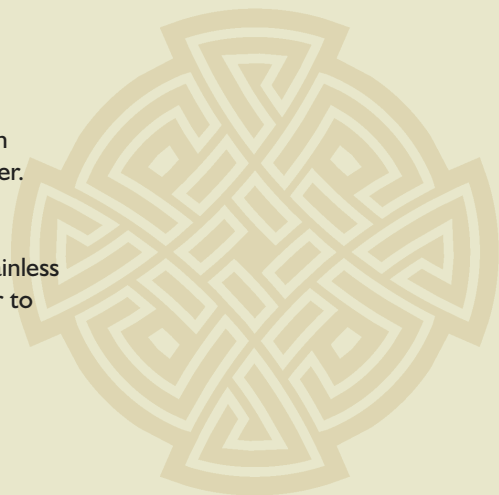

site plan

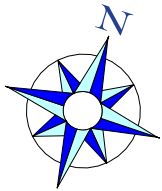

new homes

16 The Strand, Dawlish EX7 9PS

Tel: 01626 863140

Fax: 01626 866991

www.fulfords.co.uk

Celtic Fields Sales Office Tel: 01626 866767

Disclaimer

It is not possible in a brochure of this kind to do more than convey a general impression of the range, quality and variety of the properties on offer. The artist's impressions, photographs, floor plans, configurations and layouts are included for guidance only. The Developer and Agents therefore gives notice to prospective purchasers that none of the material issued or visual depictions of any kind made on behalf of the Developer and Agent can be relied upon as accurately describing in relation to any particular or proposed house or development of the company, as of the Specified Matters from time to time prescribed under the property Misdescription Act 1991, which is effective from April 1993. All such matters must be treated as intended only as a single illustration and guidance. They are subject to change from time to time without notice and their accuracy is not guaranteed, nor do they constitute a contract, part of a contract or warranty. Prospective purchasers are therefore requested to check before entering into negotiations as to whether the specification has changed.
Designed and printed by **the roman group**, Bournemouth

From Exeter – Follow A379 Exeter Road towards Dawlish Town Centre. Turn right into East Cliff Road and Celtic Fields can be found towards the top of the road on the right hand side.

From Dawlish Town Centre – Follow A379 towards Exeter past the motorcycle garage on the left. Continue for about 200 yards and take the 2nd left hand turning into East Cliff Road. Celtic Fields can be found towards the top of the road on the right hand side.

